

SEAL

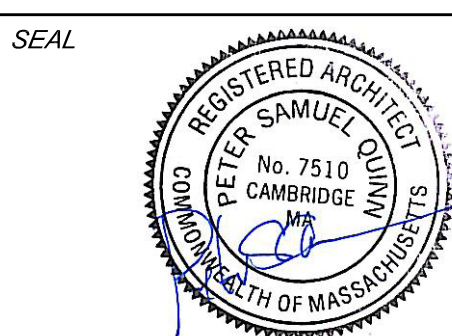

CONSULTANT

PROJECT

**SOMERVILLE DISPENSARY**

240 ELM STREET  
SOMERVILLE, MA 02144

PREPARED FOR

**SAGE NATURALS, INC. (F.N.A SAGE CANNABIS)**

13 COMMERCIAL WAY  
MILFORD, MA 01757

DRAWING TITLE

**PROPOSED BASEMENT PLAN (REVISED)**

SCALE AS NOTED

REVISION / ISSUE	DATE
SP-AMEND	MAY 11, 2017
PERMIT SET	APRIL 10, 2017
DRAWN BY WFD / AMF	REVIEWED BY PQ

SHEET

**A1.1**

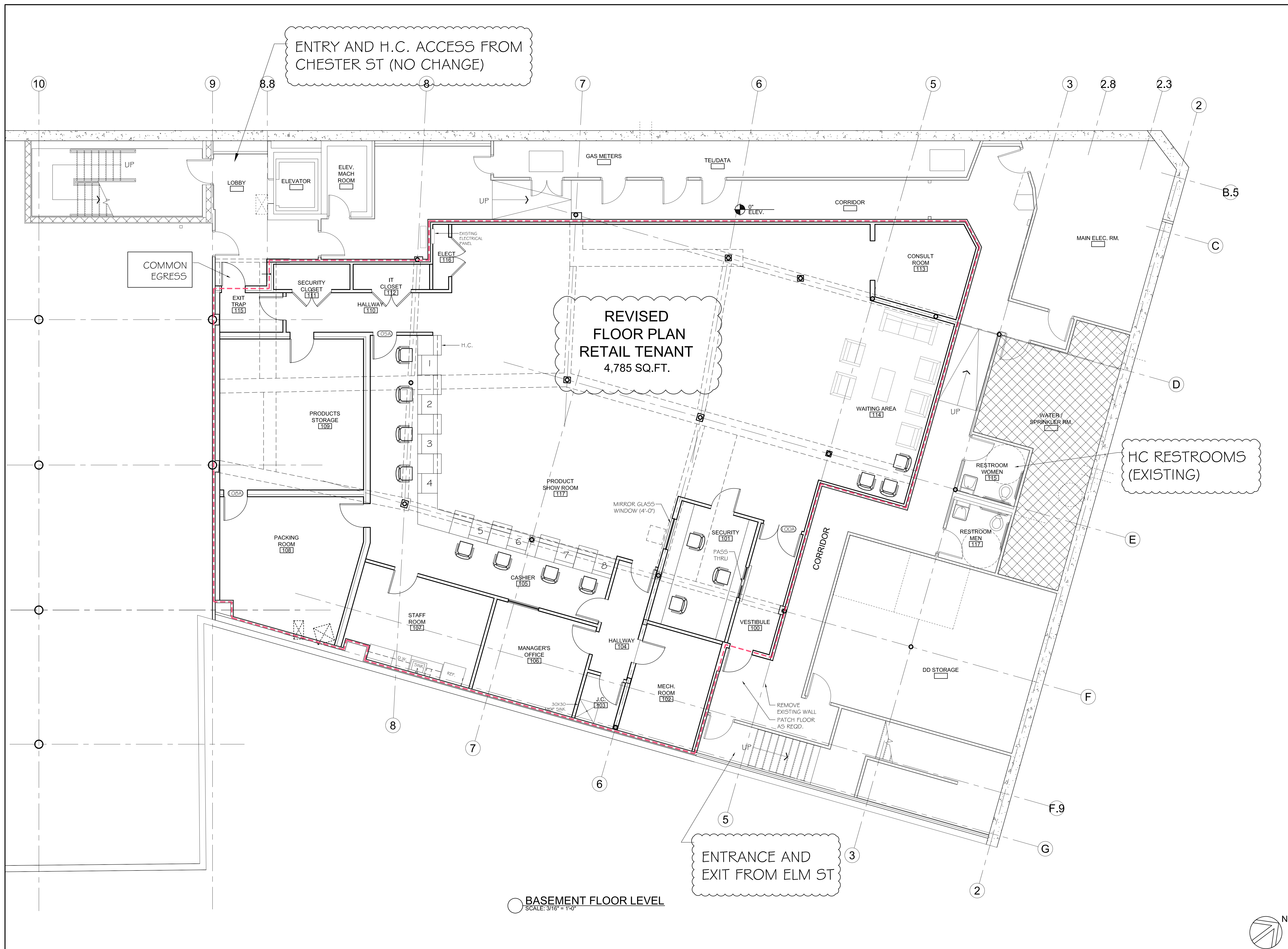

**BASEMENT FLOOR LEVEL**  
SCALE: 3/16" = 1'-0"